

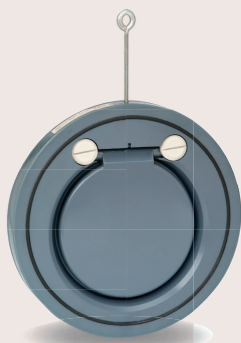

# WAFER CHECK VALVE



(W/O Spring)  
(無彈簧)  
JT 300



(W/ Spring)  
(有彈簧)  
JT 300S

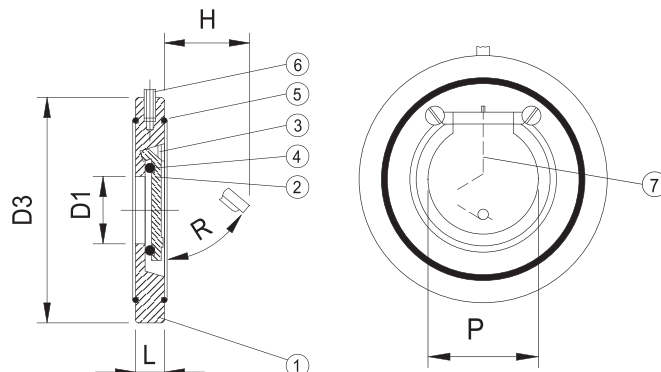

## JT Series

## 單片逆止閥

SIZE: DN40 ~ DN600

Applications (使用場合):

- Water and waste water treatment 水及廢水處理
- Chemical Industrial 化工工業
- Environmental Industrial 環境工程
- Process Industrial 加工生產工程
- Systems engineering 管路系統工程

Features (特點):

- Require little space in piping system 產品造型簡潔
- Economical - Simple and durable construction 經濟簡單, 結構耐用
- Easy Installation- Wafer Body to slip between standard flanges 安裝簡單, 夾示裝在一般法蘭和法蘭間
- Light Weight 重量輕
- Chemical Resistant 耐化學
- No corrosion 抗腐蝕

### MATERIALS OF CONSTRUCTION

No.	Parts	Pcs.	Materials	No.	Parts	Pcs.	Materials
1	Body	1	UPVC.PP.CPVC.PVDF	5	Packing	2	EPDM.VITON
2	Flapper	1	UPVC.PP.CPVC.PVDF	6	Installation device	1	SUS304, SUS316
3	Flapper mounting screw	2	PP,PVDF	7	Spring	1	SUS304, SUS316
4	O'ring	1	EPDM.VITON				

### DIMENSIONS TABLE

Nom. Size DN (inch)	JIS Unit:mm					ANSI Unit:inch					DIN Unit:mm					Test press (kgf/cm <sup>2</sup> ) (bar)	Work press (kgf/cm <sup>2</sup> ) (bar)	Mini Back Pressure Rates psi	
	D1	D3	P	L	H	D1	D3	P	L	H	D1	D3	P	L	H				
40(1-1/2")	23	86	35	16	25	0.89	3.25	1.38	0.63	0.99	23	92	35	16	25	15	10	0.2	0.3
50(2")	32	101	47	20	46	1.26	4.00	1.85	0.79	1.80	32	107	47	20	46	15	10	0.2	0.3
65(2-1/2")	40	121	57	20	51	1.57	4.75	2.24	0.79	2.00	40	127	57	20	51	15	10	0.2	0.3
80(3")	54	131	72	20	74	2.13	5.25	2.83	0.79	2.90	54	142	72	20	74	15	10	0.25	0.3
100(4")	70	156	90	22	91	2.76	6.75	3.54	0.87	3.60	70	162	90	22	91	15	10	0.25	0.3
125(5")	92	187	114	22	96	3.64	7.63	4.48	0.87	3.77	92	187	114	22	96	15	10	0.25	0.3
150(6")	112	217	134	26	147	4.40	8.63	5.27	1.02	5.80	112	217	134	26	147	15	10	0.25	0.3
200(8")	150	267	179	35	191	5.90	10.88	7.04	1.38	7.50	150	272	179	35	191	10	7	0.3	0.3
250(10")	190	330	226	40	229	7.48	13.27	8.89	1.57	9.00	190	327	226	40	229	9	6	0.3	0.3
300(12")	216	375	264	45	259	8.62	16.01	10.39	1.77	10.20	216	375	264	45	259	9	6	0.3	0.3
350(14")	266	420	311	49	245	10.47	17.61	12.24	1.93	9.64	266	430	311	49	245	9	6	0.5	0.5
400(16")	310	483	354	65	285	12.20	20.11	13.93	2.56	11.22	310	488	354	65	285	7	5	0.7	0.6
450(18")	350	538	396	68	330	13.78	21.49	15.59	2.67	13.00	350	538	396	68	330	5	3.5	1.0	0.8
500(20")	400	593	437	78	385	15.75	23.74	17.2	3.07	15.15	400	593	437	78	385	5	3.5	1.1	1.0

※ 本尺表以 PVC 材質為準, 本表試壓值以 PVC、PVDF 材質為基準, PP 材質試壓值為本表試壓值之 70%。

※ 法蘭長度公差依據 EN558-1:1995 標準

※ 本產品有生產 6" 以上加強型, 價格另詢。

The dimension table is calculated based on PVC material.

※ The valve of test pressure is calculated based on PVC PVDF materials.

The valve of test pressure for PP material is 70% based on the table.

The flanged length tolerance is according to EN558-1:1995.